

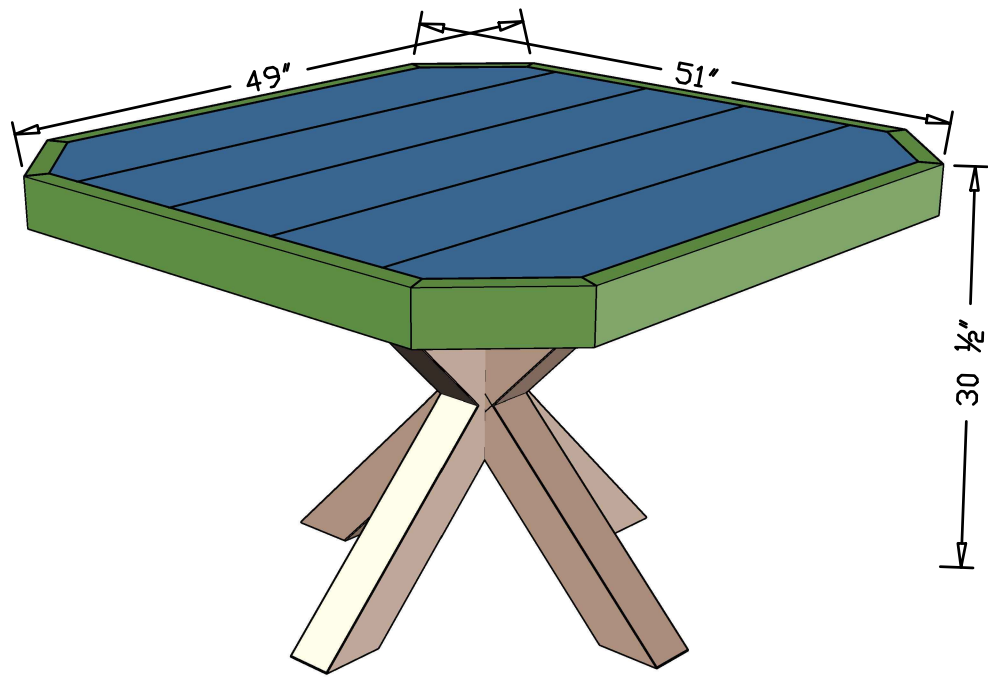

DINING TABLE

Supplies		
Item	Quantity	Description
1x10x8'	3	
2x4x8'	4	Construction lumber
4x4x8'	2	Construction lumber
1 ¼" Pocket Hole Screws		
2" Wood Screws		
2 ½" Wood Screws		



Cut List

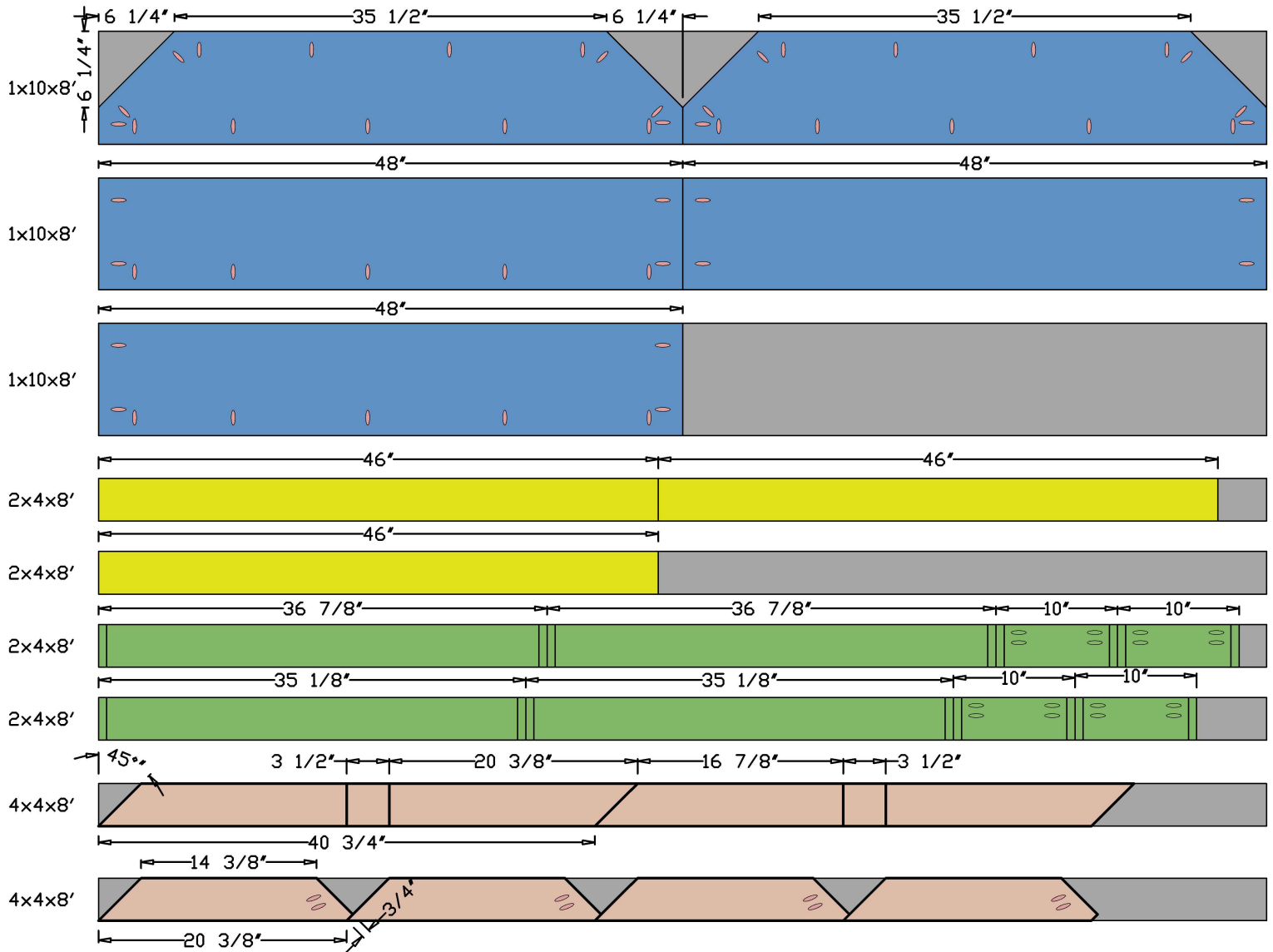

Step 1

Take 1x10 boards and cut them to 48" long (x5). Two of the boards will have 45° cut on each side. Follow cut list dimensions. Then drill pocket holes as shown on the cut list. Assemble the top boards together using 1 1/4" pocket hole screws.

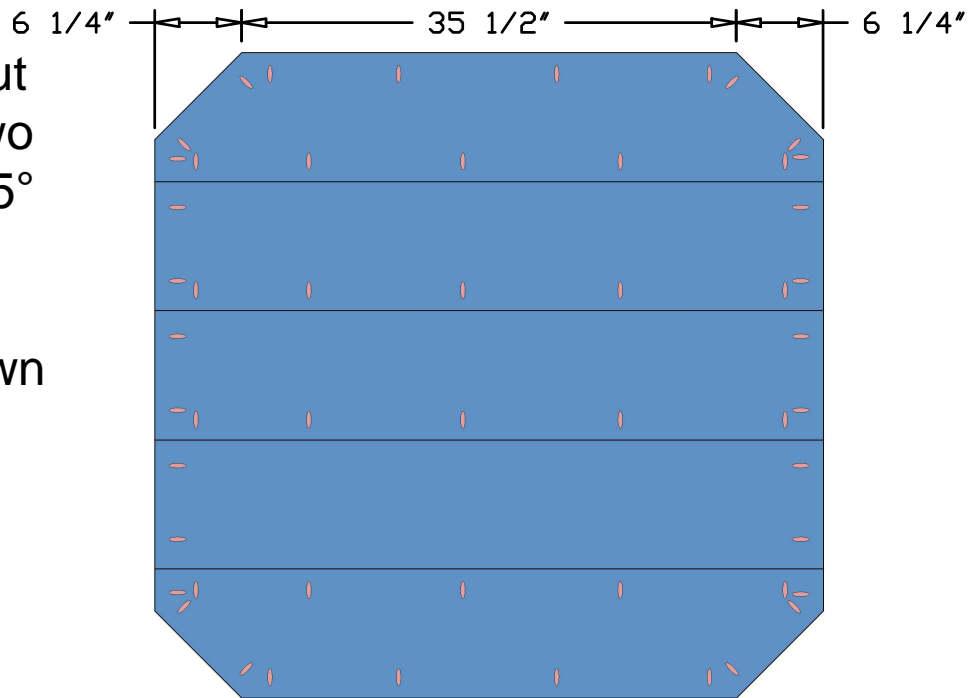

POCKET HOLES
FOR 1 1/4"
SCREWS

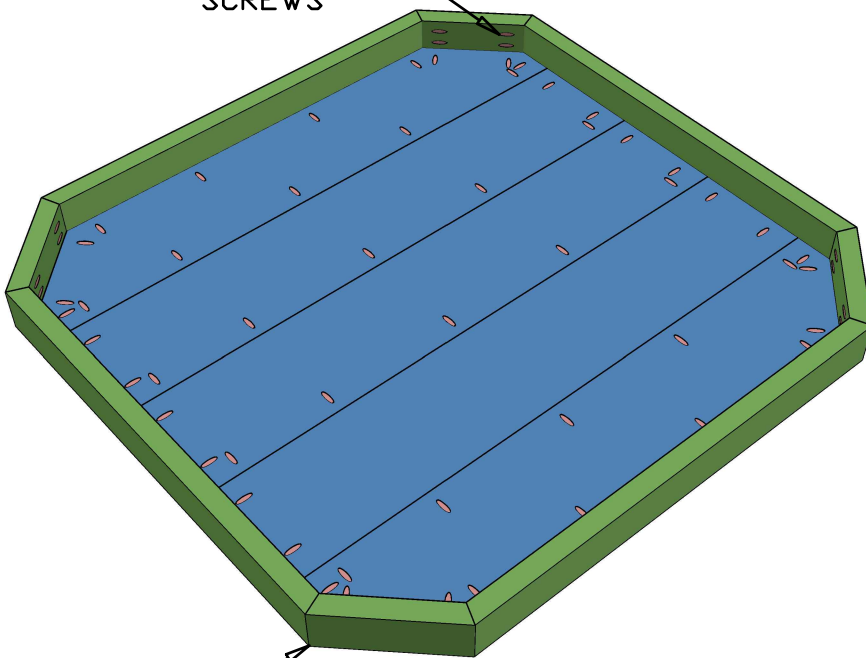

ALL 2X4
CORNERS ARE
22.5 DEGREES

Step 3

To build the legs, take 4x4 and cut it to 40 3/4" long at 45° on both sides (x2). Cut 1 3/4" deep and 3 1/2" wide notch in the center.

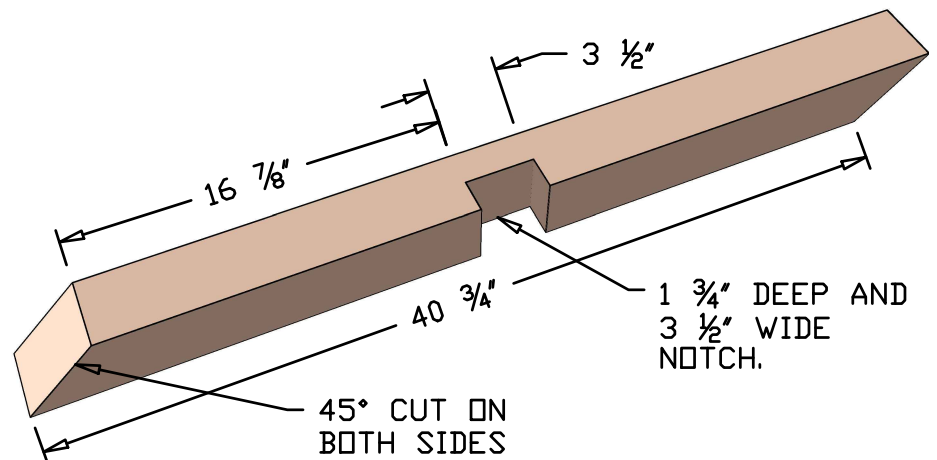

Step 2

To cut the 2x4s around the perimeter of the table top accurately, each side would need to be measured separately. The 2x4s will need to be cut at 22.5°. The small 2x4s will have pocket holes for 1 1/4" screws to hold them together.

Step 4

Apply wood glue inside the notch cutout and slide one notch into the other to make an X. Use 2 ½" wood screw to hold the X together.

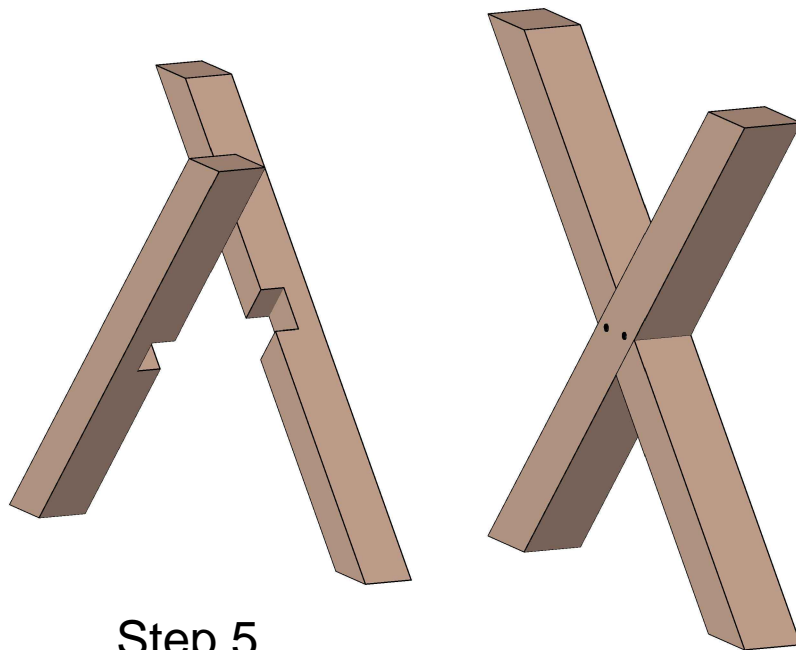

Step 5

Cut the remaining 4x4 to provided dimensions in the cut list. Drill two pocket holes on each side for 2 ½" screws.

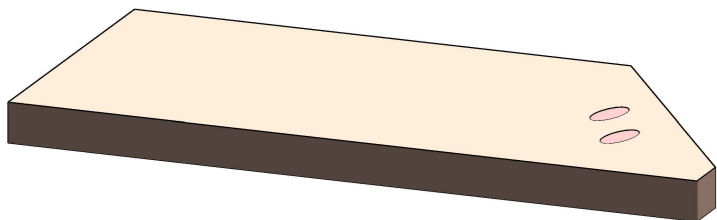

Step 6

Draw a horizontal line in the center of the X. Find a flat surface. Place the lower 4x4 legs at the horizontal line and attach it using 2 ½" pocket hole screws. Once the lower legs are attached, do the same thing with the upper 4x4 legs.

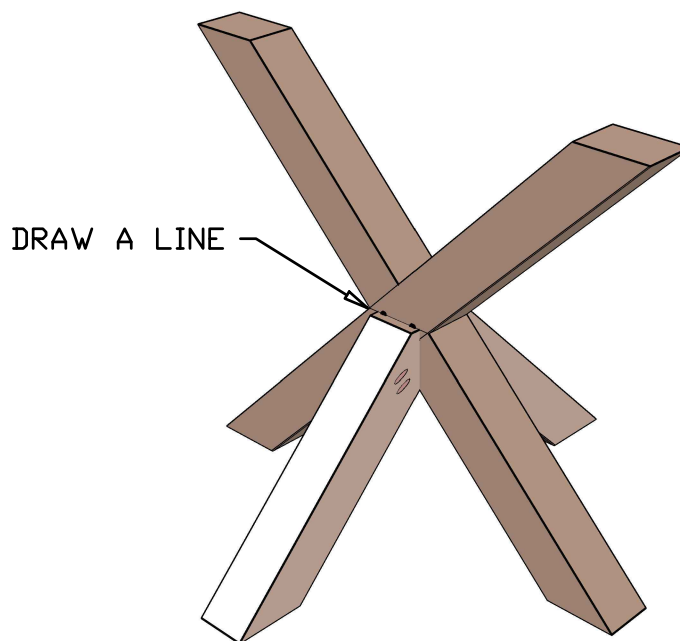

Step 7

Take 2x4 and cut it 46" long (x3). Attach one 2x4 using 2" wood screws in the center and the other two spaced out so that upper legs would land on these 2x4. You're done with this dining table.

