

ANAWHITEKNOCK-OFFWOOD

100s OF FREE AND EASY KNOCK-OFF FURNITURE PLANS TO SAVE YOU \$1000s

PLANS: Locker for the Cube Collection and Small Hutch

Compare to: Land of Nod Cube Collection, Locker

Skill Level: Beginner

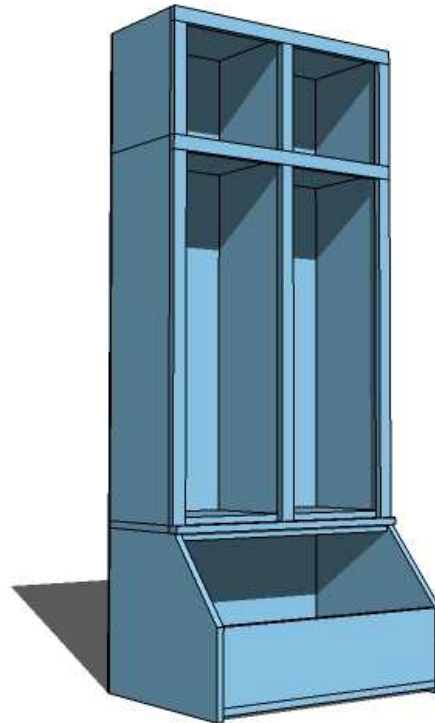

Locker for the Cube Collection

So easy to build and versatile, this simple cube bench can go beyond the kids room. Store shoes in your entryway, towels in your bathroom, or create a reading nook in your child's room by adding the tower cubes. Sized to fit standard fabric cubes, clutter can be contained easily with this system.

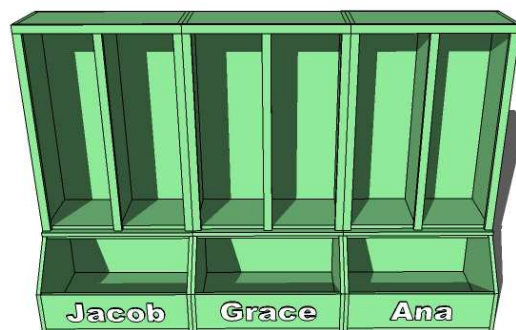

Copyrighted Material

See www.knock-offwood.com for full disclaimer

ANAWHITEKNOCK-OFFWOOD

100s OF FREE AND EASY KNOCK-OFF FURNITURE PLANS TO SAVE YOU \$1000s

PLANS: Locker for the Cube Collection and Small Hutch

SHOPPING LIST FOR THE LOCKER & HUTCH

Quantity	Description
4	1x12, 8' Long
3	1x2s, 8' Length
2"	Screws
	¼" Plywood
	1 1/4" Finish Nails
	2" Finish Nails
1	Small Tube Wood Glue
	Sandpaper
	Finishing Supplies including wood filler

RECOMMENDED TOOLS

Measuring Tape, Square, Saw, Drill with Countersink Bit, Finish Nailer, Sander, Clamps

CUT LIST FOR THE LOCKER

	Quantity	Board	Length	Description
A	2	1x12	27"	Top and Bottom
B	2	1x12	39 "	Sides
C	2	1x12	37 1/2"	Divider
D	4	¼" Plywood	28 ½" x 39"	Back
E	1	1x2	28 1/2"	Top Trim
F	3	1x2	37 ½"	Cubby Divider Trim

CUT LIST FOR THE SMALL HUTCH

	Quantity	Board	Length	Description
A	1	1x12	27"	Top
B	2	1x12	13 "	Sides
C	2	1x12	12 1/4"	Divider
D	4	¼" Plywood	28 ½" x 13"	Back
E	1	1x2	28 1/2"	Top
F	3	1x2	11 ½"	Cubby Divider Trim

Copyrighted Material

See www.knock-offwood.com for full disclaimer

ANAWHITEKNOCK-OFFWOOD

100s OF FREE AND EASY KNOCK-OFF FURNITURE PLANS TO SAVE YOU \$1000s

PLANS: Locker for the Cube Collection and Small Hutch

IN GENERAL

Refer to the blog at www.knock-offwood.com for any comments or suggestions for this plan. Always wear necessary safety equipment and take safety precautions. Check for square after each step. Measure all joints out and mark clearly with a square on BOTH sides of the joint (so you know where to nail). Use glue unless otherwise stated. Always predrill and countersink any screws. If you are using MDF, avoid fastening too close to the edges to avoid splitting your MDF.

It is recommended that the locker be attached to the wall to avoid tipping, and the small hutch also be attached to the locker and the wall.

Copyrighted Material

See www.knock-offwood.com for full disclaimer

ANAWHITEKNOCK-OFFWOOD

100s OF FREE AND EASY KNOCK-OFF FURNITURE PLANS TO SAVE YOU \$1000s

PLANS: Locker for the Cube Collection and Small Hutch

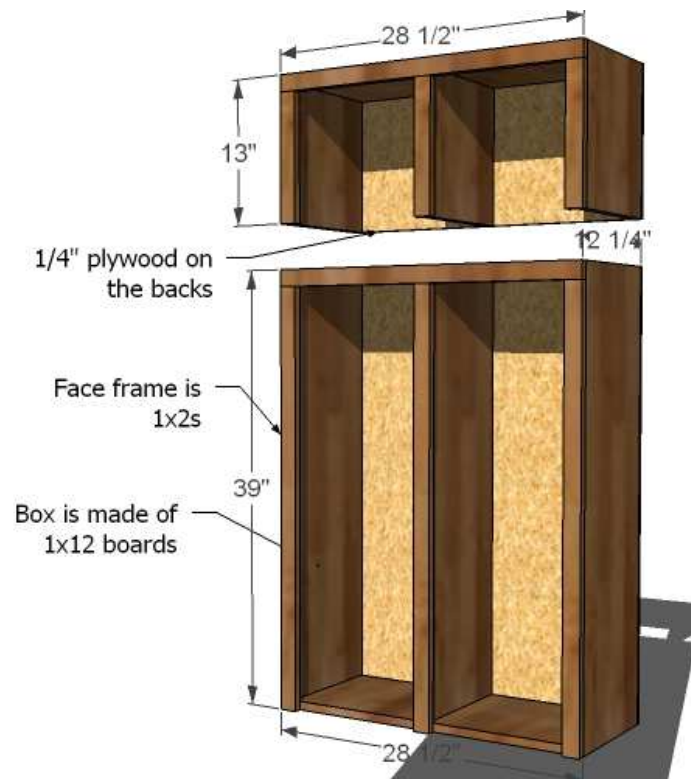

DIMENSIONS AND COMPOSITION

Dimensions and composition are shown above. The most inexpensive options for the finish are detailed below.

FOR PAINTED FINISH use MDF cut into 11 1/2" wide strips or primed MDF boards at least 11" wide or MDF shelving 11 1/2" wide. Boards do not need to be exactly 11 1/2" wide (as a standard dimensional 1x12 is). Frame the piece out in pine 1x2s or hardwood 1x2s for increased strength. Seal with primer before painting.

FOR RUSTIC SOLID WOOD FINISH (Think Pottery Barn Kid's Thomas Collection) Build the box out of 1x12 boards (choose straight 1x12s) and trim with 1x2s made of pine or whitewood. You may need to add wood conditioner to the wood to keep the stain from going on "blotchy."

FOR THE FRAMED IN SOLID HARDWOOD FINISH Buy A1 Plywood in the hardwood of choice (for example, maple) and have the plywood cut at the hardware store into 11 1/2" wide strips. These strips are now referred to as 1x12s. Buy matching hardwood 1x2s for the legs and face framing.

Copyrighted Material

See www.knock-offwood.com for full disclaimer

ANAWHITEKNOCK-OFFWOOD

100s OF FREE AND EASY KNOCK-OFF FURNITURE PLANS TO SAVE YOU \$1000s

PLANS: Locker for the Cube Collection and Small Hutch

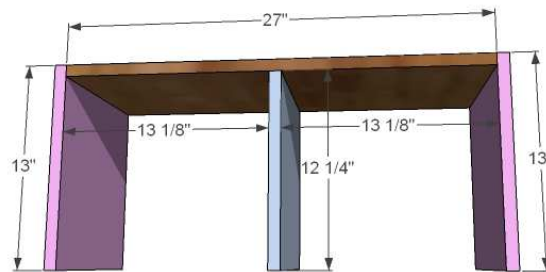
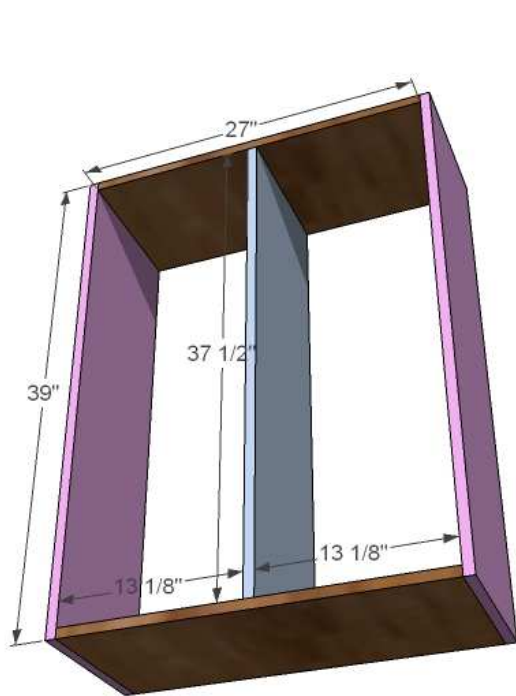

STEP 1: BUILD THE BOX

Mark out all of your joints as shown in the diagram on the cut pieces. Pre-drill and countersink all screws, using 2" screws and glue. Adjust for square. You can also use 2" finish nails and glue, as the locker will be fully framed and have a plywood back.

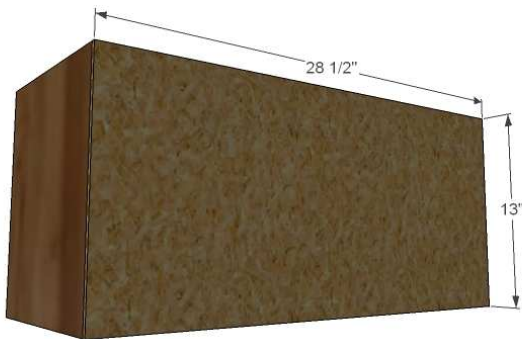

STEP 2: BACK

Attach the back with glue and 1 1/4" finish nails. Make sure you also attach to the center divider too.

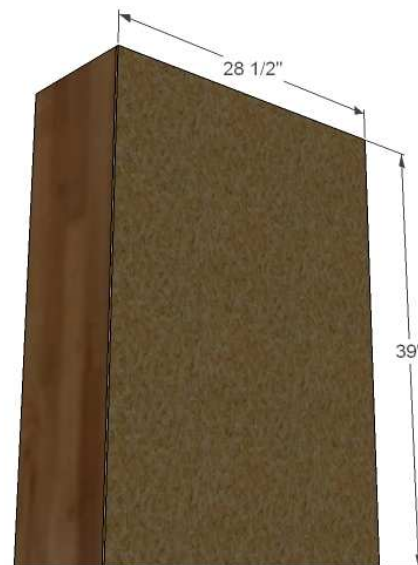

Copyrighted Material

See www.knock-offwood.com for full disclaimer

ANA WHITE KNOCK-OFF WOOD

100s OF FREE AND EASY KNOCK-OFF FURNITURE PLANS TO SAVE YOU \$1000s

PLANS: Locker for the Cube Collection and Small Hutch

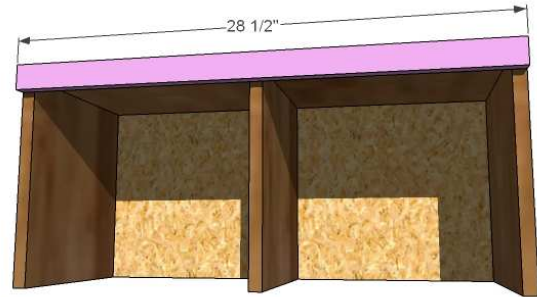

STEP 3: TOP TRIM

Use 1 1/4" finish nails and glue to attach the top trim. Make sure you attach the top trim to both the sides and the top (and the dividers too).

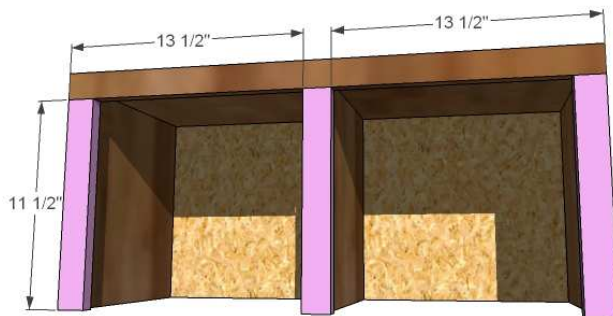

STEP 4: VERTICAL TRIM

Attach the vertical trim to the sides and dividers as shown here, using glue and 1 1/4" finish nails.

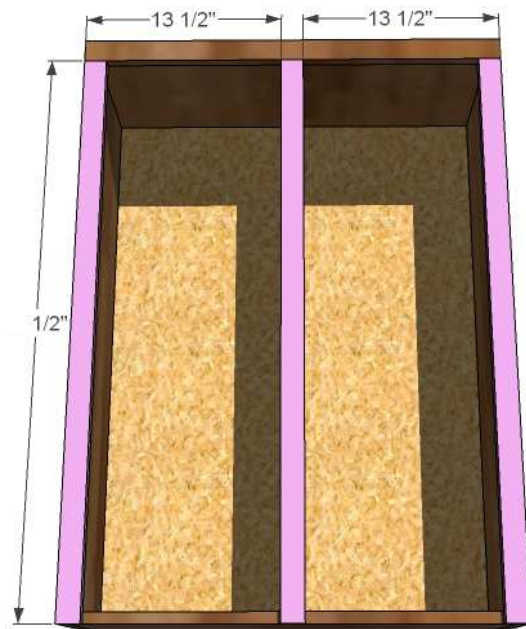

Copyrighted Material

See www.knock-offwood.com for full disclaimer

ANAWHITEKNOCK-OFFWOOD

100s OF FREE AND EASY KNOCK-OFF FURNITURE PLANS TO SAVE YOU \$1000s

PLANS: Locker for the Cube Collection and Small Hutch

FINISHING

Fill all holes with wood filler. Sand with coarse sandpaper. Fill holes with wood filler again, and sand with medium grit sandpaper. Then finish with a fine sandpaper. Always sand in the direction of the wood grain. If you are painting, prime, painting the insides first, outsides last. Add two coats of paint. You can add a clear top coat if you wish. For staining, always test out a scrap piece, with wood filler. If the wood filler is not taking stain, you may wish to buy a color coordinated wood filler and fill your holes with this. If the stain is going on blotchy, you may need to apply a wood conditioner prior to the stain. Apply a top coat if necessary.

Copyrighted Material

See www.knock-offwood.com for full disclaimer