

# ANAWHITEKNOCK-OFFWOOD

100s OF FREE AND EASY KNOCK-OFF FURNITURE PLANS TO SAVE YOU \$1000s

PLANS: Tryde Media Hutch

**Compare to:** Pottery Barn Hyde Media Console

**Skill Level:** Intermediate



## Tryde Media Hutch

Following the great success of so many readers with the Tryde Collection, inspired by Pottery Barn's popular Hyde Collection, the Tryde Media console hutch is substantial and rustic, built with pine, and will be heavy and strong. Plans for the Coffee Table, End Table and Console Table available at [www.knock-offwood.com](http://www.knock-offwood.com). This plan works with the Tryde Media console, also pictured.

Copyrighted Material

See [www.knock-offwood.com](http://www.knock-offwood.com) for full disclaimer

# ANAWHITEKNOCK-OFFWOOD

100s OF FREE AND EASY KNOCK-OFF FURNITURE PLANS TO SAVE YOU \$1000s

PLANS: Tryde Media Hutch

## SHOPPING LIST

Quantity	Description
2	1x12, 12' Long
3	1x2, 8' Long
16	1x4s, 10' Length
2"	Screws
	1 1/4" Finish Nails
	2" Finish Nails
1	Small Tube Wood Glue
	Sandpaper
	Finishing Supplies including wood filler

## RECOMMENDED TOOLS

Measuring Tape, Square, Saw, Drill with Countersink Bit, Finish Nailer, Sander, Clamps

## CUT LIST

	Quantity	Board	Length	Description
A	2	1x12	52 1/2"	Sides
B	2	1x12	53 "	Top and Shelf
C	2	1x12	15"	Cubby Divider
D	16	1x4	54 1/2"	Back and Header
E	2	1x2	49"	Side Trim
F	2	1x2	54 1/2"	Crown

## IN GENERAL

Copyrighted Material

See [www.knock-offwood.com](http://www.knock-offwood.com) for full disclaimer

# ANAWHITEKNOCK-OFFWOOD

100s OF FREE AND EASY KNOCK-OFF FURNITURE PLANS TO SAVE YOU \$1000s

## PLANS: Tryde Media Hutch

Refer to the blog at [www.knock-offwood.com](http://www.knock-offwood.com) for any comments or suggestions for this plan. Always wear necessary safety equipment and take safety precautions. Check for square after each step. Measure all joints out and mark clearly with a square on BOTH sides of the joint (so you know where to nail). Use glue unless otherwise stated. Always predrill and countersink any screws. If you are using MDF, avoid fastening too close to the edges to avoid splitting your MDF.

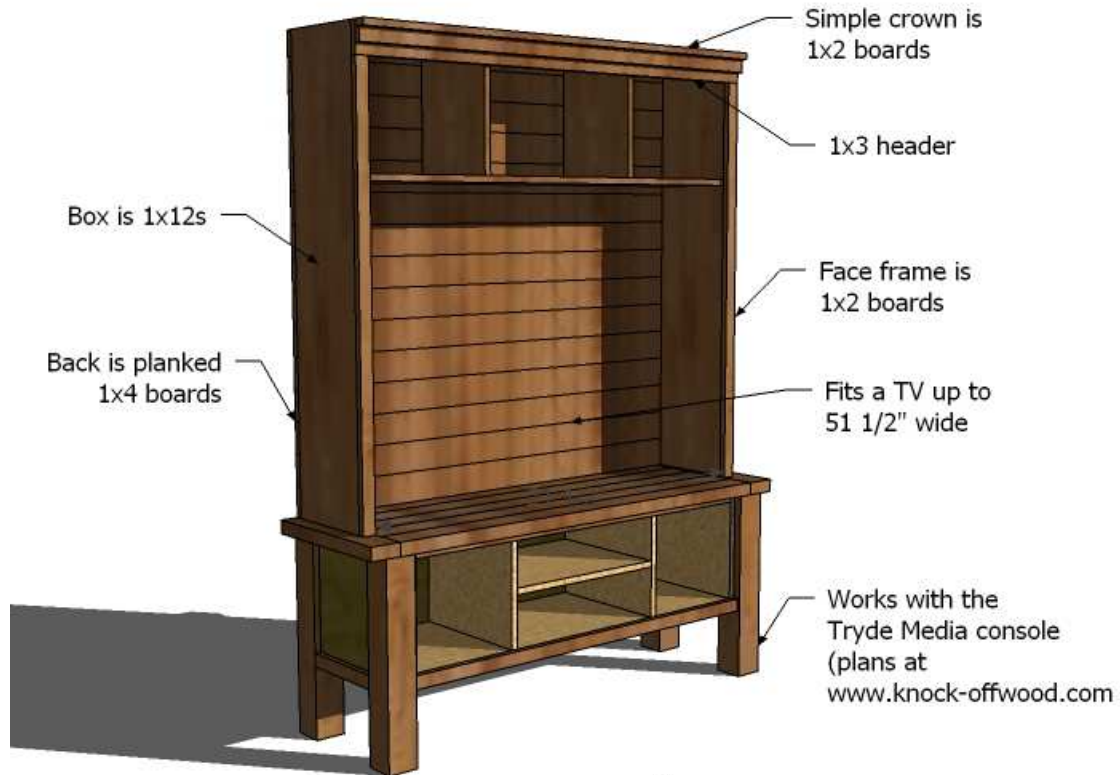

## DIMENSIONS AND COMPOSITION

The hutch is built from solid wood, preferably pine or whitewood boards that are straight, but contain lots of character. Dimensions are shown to the right. Header is made of a 1x4.



Copyrighted Material

See [www.knock-offwood.com](http://www.knock-offwood.com) for full disclaimer

# ANAWHITEKNOCK-OFFWOOD

100s OF FREE AND EASY KNOCK-OFF FURNITURE PLANS TO SAVE YOU \$1000s

PLANS: Tryde Media Hutch

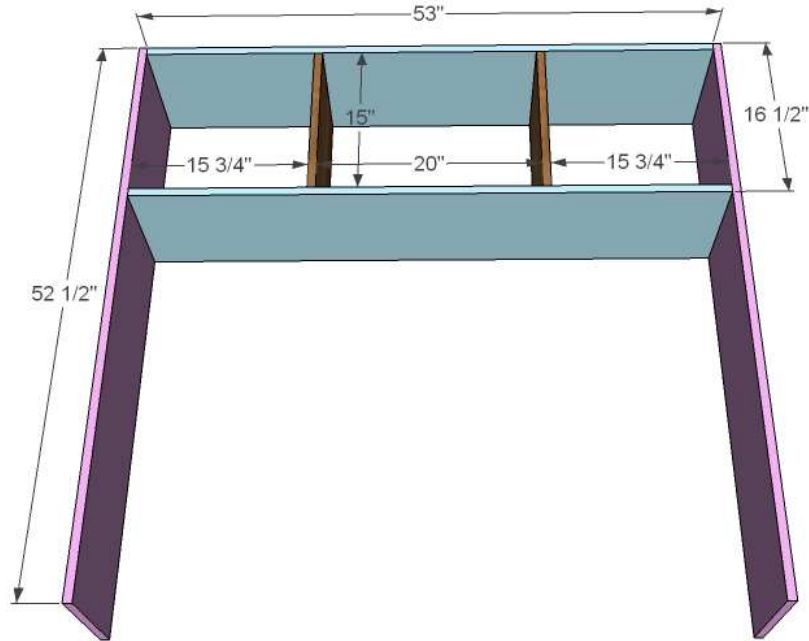

## STEP 1: BUILD THE BOX

Mark out all of your joints as shown in the diagram on the cut pieces. Predrill and countersink all screws, using 2" screws and glue. Adjust for square.

## STEP 2: BACK

Attach the back with 2" screws or nails and glue. Adjust for square after each board. It's also a good idea to use pocket hole screws to join each board together, edge to edge. You can also use tongue and groove paneling.

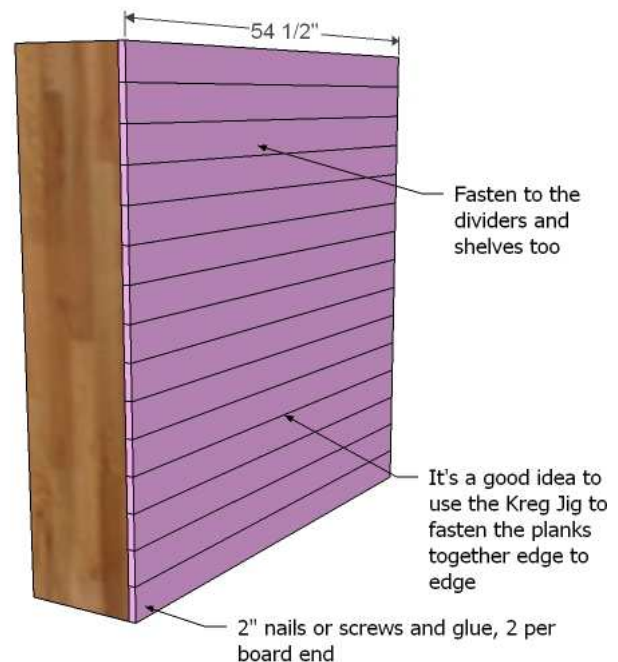

Copyrighted Material

See [www.knock-offwood.com](http://www.knock-offwood.com) for full disclaimer

# AN WHITE KNOCK-OFF WOOD

100s OF FREE AND EASY KNOCK-OFF FURNITURE PLANS TO SAVE YOU \$1000s

PLANS: Tryde Media Hutch

## STEP 3: HEADER

Attach the header to the top, keeping outside edges flush. Use 2" nails and glue and also attach to the vertical dividers.



## STEP 4: SIDE TRIM

Attach the side trim to the sides, keeping outside edges flush. Use 1 1/4" nails and glue. Don't forget to nail to the shelf.

Copyrighted Material

See [www.knock-offwood.com](http://www.knock-offwood.com) for full disclaimer

# ANAWHITEKNOCK-OFFWOOD

100s OF FREE AND EASY KNOCK-OFF FURNITURE PLANS TO SAVE YOU \$1000s

PLANS: Tryde Media Hutch



## STEP 5: CROWN

Stack the crown and attach it to the header as shown above. Use 1 1/4" nails and glue. Also add 2" nails to the face of the purple board, nailing through the face into the top edge of the hutch.

## STEP 6: ASSEMBLY

It is recommended that you attach the hutch securely to the wall behind the console to avoid tipping hazards.

## FINISHING

Fill all holes with wood filler. Sand with coarse sandpaper. Fill holes with wood filler again, and sand with medium grit sandpaper. Then finish with a fine sandpaper. Always sand in the direction of the wood grain. If you are painting, prime, painting the insides first, outsides last. Add two coats of paint. You can add a clear top coat if you wish. For staining, always test out a scrap piece, with wood filler. If the wood filler is not taking stain, you may wish to buy a color coordinated wood filler and fill your holes with this. If the stain is going on blotchy, you may need to apply a wood conditioner prior to the stain. Apply a top coat if necessary.

Copyrighted Material

See [www.knock-offwood.com](http://www.knock-offwood.com) for full disclaimer