

ANAWHITEKNOCK-OFFWOOD

100s OF FREE AND EASY KNOCK-OFF FURNITURE PLANS TO SAVE YOU \$1000s

PLANS: Twin Brookstone Desk Hutch

Compare to: Pottery Barn Kids Brookfield Desk Hutch

Skill Level: Beginner

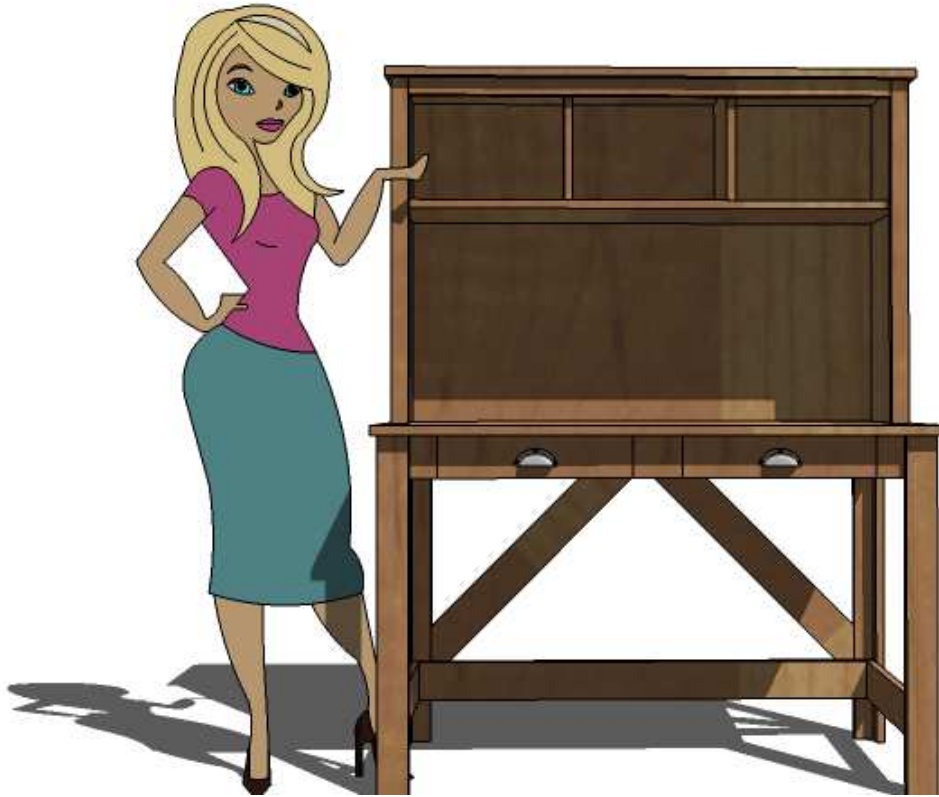

Brookstone Desk Hutch

Fitting with the Brookstone Desk, the Brookstone Desk Hutch is super easy to build. Built from solid pine boards (like the Pottery Barn Kids Brookfield Desk Hutch), this hutch can be stained and distressed to achieve a rustic finish. Customize it to suit your needs by adding corkboard as the backing or even peg board and hooks. Image shown above with the woman standing (in heels) at 5'7" tall.

Copyrighted Material

See www.knock-offwood.com for full disclaimer

ANAWHITEKNOCK-OFFWOOD

100s OF FREE AND EASY KNOCK-OFF FURNITURE PLANS TO SAVE YOU \$1000s

PLANS: Twin Brookstone Desk Hutch

SHOPPING LIST

Quantity	Description
1	¼" Plywood, ½ of a sheet
2	1x2s, 8' Length
4	1x4, 6' Length (could also be a 1x3 to save money) 1 ¼" and 2" Finish Nails
1	Small Tube Wood Glue Finishing Supplies including wood filler and sandpaper, knobs or pulls

RECOMMENDED TOOLS

Measuring Tape, Square, Saw, Finish Nailer, Drill with Countersink Bits, Sander, Clamps, Compass or Miter Saw

CUT LIST

	Quantity	Board	Length	Description
A	1	1x12	46"	Top
B	1	1x12	43 ½"	Shelf
C	2	1x12	10 1/2"	Dividers
D	2	1x12	30"	Sides
	1	1x4	43 ½"	Back Support (to save money, you can use a 1x3 or 1x2 here.)
E	1	¼" Plywood	45"x30 3/4"	Back (You can also use peg board or corkboard or other creative materials)
F	2	1x2	30"	Side Trim
G	1	1x2	42"	Header
H	1	1x2	46"	Crown

IN GENERAL

Refer to the blog at www.knock-offwood.com for any comments or suggestions for this plan. Always wear necessary safety equipment and take safety precautions. Check for square after each step. Measure all joints out and mark clearly with a square on BOTH sides of the joint (so you know where to nail). Use glue unless otherwise stated. Always predrill and countersink any screws. If you are using MDF, avoid fastening too close to the edges to avoid splitting your MDF.

Copyrighted Material

See www.knock-offwood.com for full disclaimer

ANAWHITEKNOCK-OFFWOOD

100s OF FREE AND EASY KNOCK-OFF FURNITURE PLANS TO SAVE YOU \$1000s

PLANS: Twin Brookstone Desk Hutch

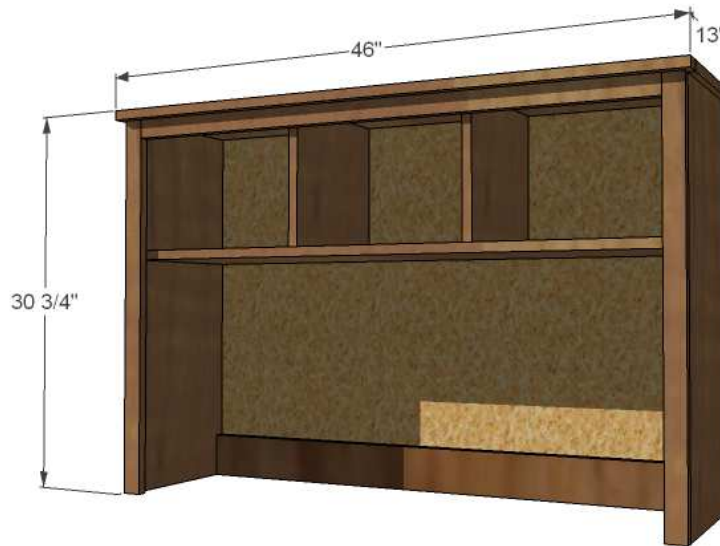

DIMENSIONS AND COMPOSITION

Dimensions and composition are shown above. Like the Pottery Barn Kids Brookfield Desk Hutch, the recommended composition is solid pine or whitewood boards.

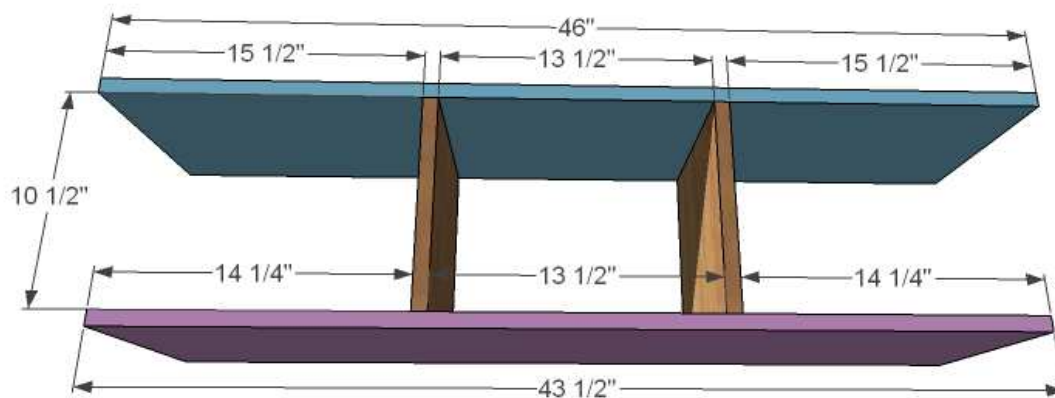

STEP 1: BUILD THE BOX (or three boxes)

Because a hutch is a low use stationary item, you can use 2" finish nails. Finish nails are easy to do with a pneumatic nailer, and will be easy to hide. Just make sure you mark out all joints prior to getting your nailer out. Notice that the top board is longer than the bottom.

Copyrighted Material

See www.knock-offwood.com for full disclaimer

ANAWHITEKNOCK-OFFWOOD

100s OF FREE AND EASY KNOCK-OFF FURNITURE PLANS TO SAVE YOU \$1000s

PLANS: Twin Brookstone Desk Hutch



STEP 2: SIDES

Mark the sides as shown above, and then use 2" finish nails and glue to attach the sides to the box. The top will overhang the sides by 1/2".

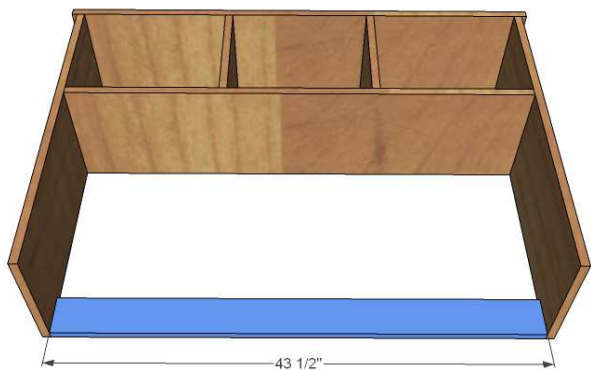

STEP 3: BACK SUPPORT

Use 2" nails and glue to attach the back support to the bottom of the hutch as shown in the diagram.

Copyrighted Material

See www.knock-offwood.com for full disclaimer

ANAWHITEKNOCK-OFFWOOD

100s OF FREE AND EASY KNOCK-OFF FURNITURE PLANS TO SAVE YOU \$1000s

PLANS: Twin Brookstone Desk Hutch

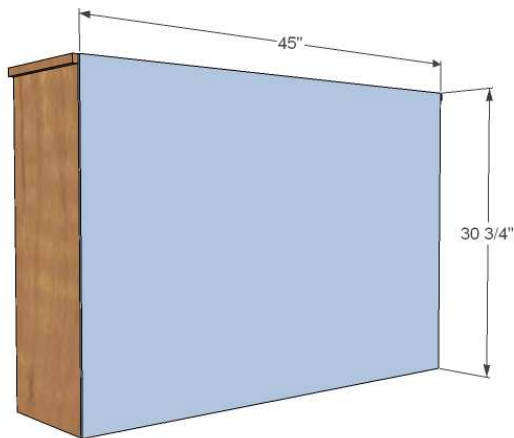

STEP 4: BACK

The most important part about the back is nailing it on square. Start with having a square piece of plywood to work with. Then Adjust the hutch for square. Apply glue to all of the board edges and then lay the plywood on top. Adjust again so outside edges are flush. Use 1 1/4" finish nails (2" are fine too but overkill and more expensive) to nail the back down. Don't forget to nail also to the back support.

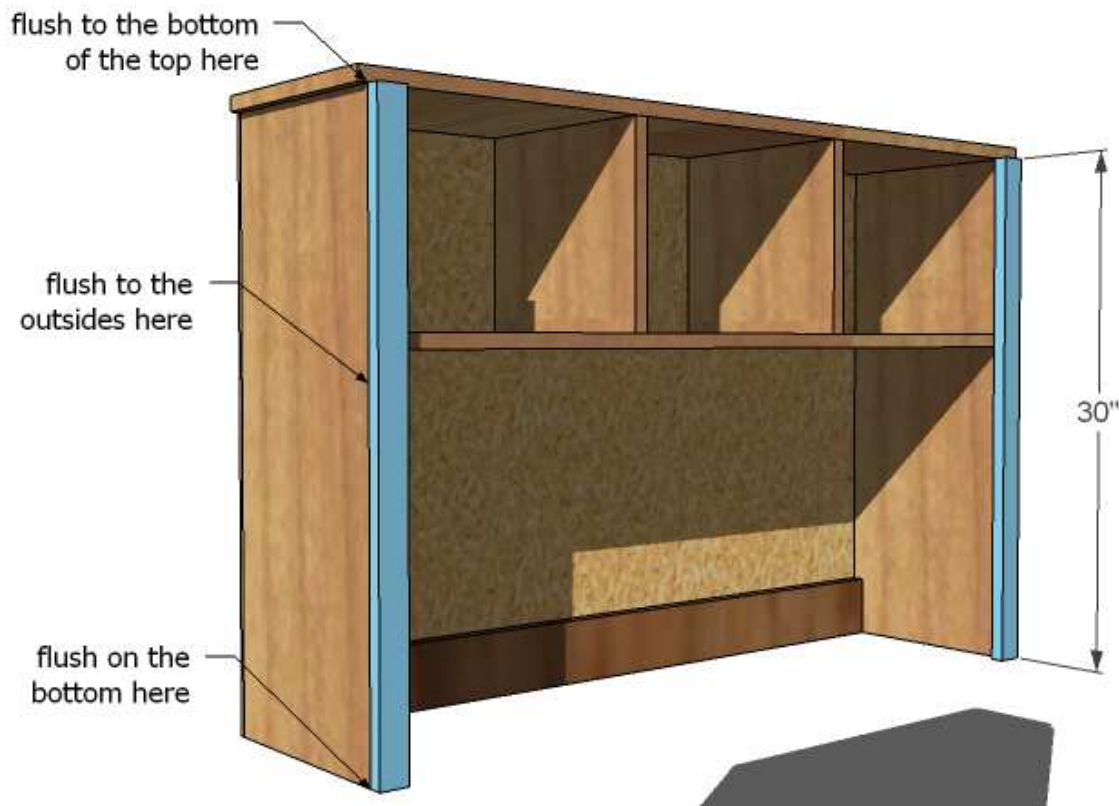

STEP 5: 1x2 SIDE TRIM

Attach the 1x2 side trim to the sides as shown above. Keep bottom and outside edges flush. Use glue and 2" nails. Don't forget to also add a nail to the shelf.

Copyrighted Material

See www.knock-offwood.com for full disclaimer

ANAWHITEKNOCK-OFFWOOD

100s OF FREE AND EASY KNOCK-OFF FURNITURE PLANS TO SAVE YOU \$1000s

PLANS: Twin Brookstone Desk Hutch

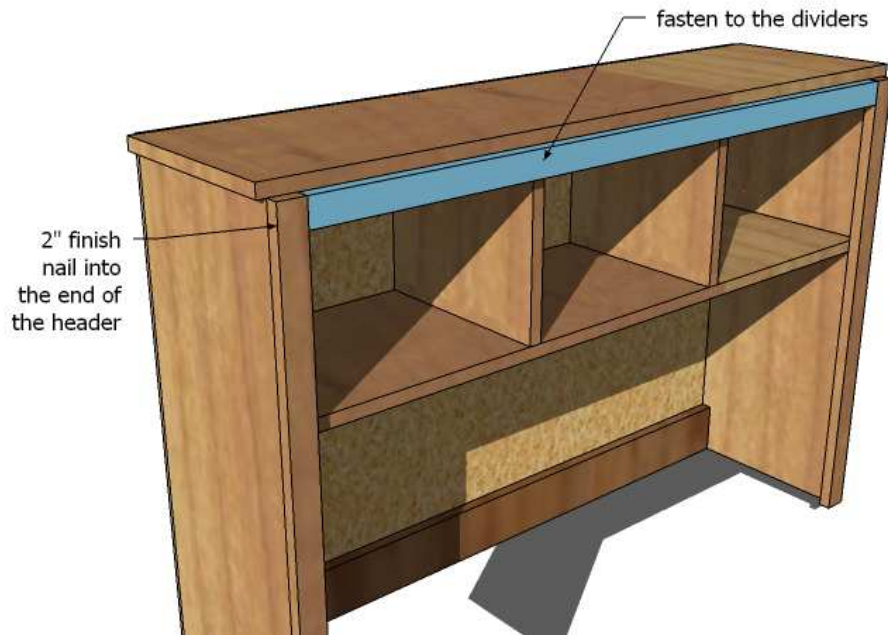

STEP 6: HEADER

Attach the 1x2 header to the dividers, keeping to edge in line with the bottom edge of the hutch top. The ends of the header will run flush with the side trim edge. Don't forget to add a 2" nail through the side trim into the end edge of the header.

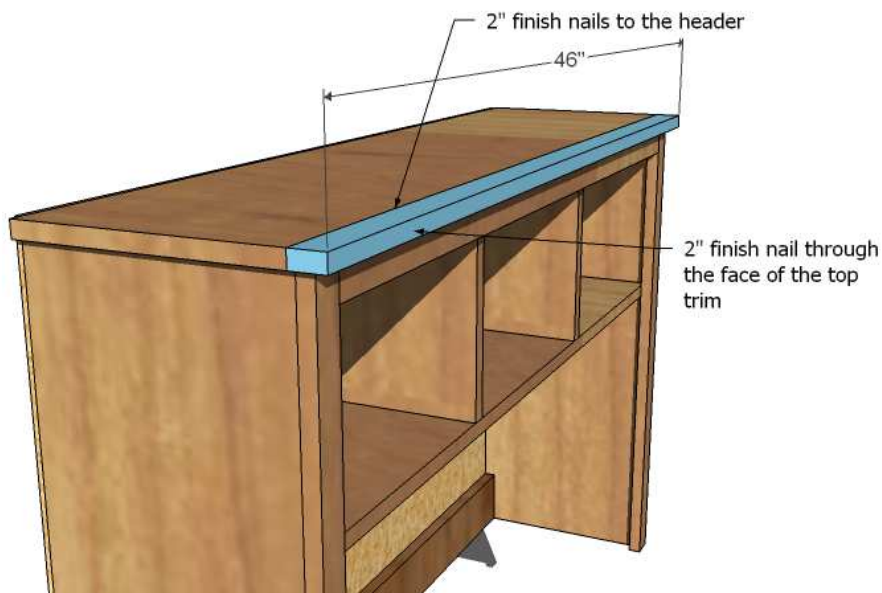

STEP 7: CROWN

Attach the front crown as shown in the diagram, nailing with 2" nails and glue through both the face and the top of the crown into the hutch. End edges should be flush with the top of the hutch.

Copyrighted Material

See www.knock-offwood.com for full disclaimer

ANAWHITEKNOCK-OFFWOOD

100s OF FREE AND EASY KNOCK-OFF FURNITURE PLANS TO SAVE YOU \$1000s

PLANS: Twin Brookstone Desk Hutch

FINISHING

Fill all holes with wood filler. Sand with coarse sandpaper. Fill holes with wood filler again, and sand with medium grit sandpaper. Then finish with a fine sandpaper. Always sand in the direction of the wood grain. If you are painting, prime, painting the insides first, outsides last. Add two coats of paint. You can add a clear top coat if you wish. For staining, always test out a scrap piece, with wood filler. If the wood filler is not taking stain, you may wish to buy a color coordinated wood filler and fill your holes with this. If the stain is going on blotchy, you may need to apply a wood conditioner prior to the stain. Apply a top coat if necessary.

It is highly recommended that the hutch be secured to the desk and also a stud in the wall behind the desk. Failure to do so could result in injury or even death. Build and use at your own risk. For full disclaimer, visit www.ana-white.com

Copyrighted Material

See www.knock-offwood.com for full disclaimer