

ANAWHITEKNOCK-OFFWOOD

100s OF FREE AND EASY KNOCK-OFF FURNITURE PLANS TO SAVE YOU \$1000s

PLANS: Tryde Media Console

Compare to: Pottery Barn Hyde Media Console

Skill Level: Intermediate



Storage Bed Tower

Following the great success of so many readers with the Tryde Collection, inspired by Pottery Barn's popular Hyde Collection, the Tryde Media console is substantial and rustic, built with pine, and will be heavy and strong. Plans for the Coffee Table, End Table and Console Table available at www.knock-offwood.com.

Copyrighted Material

See www.knock-offwood.com for full disclaimer

ANAWHITEKNOCK-OFFWOOD

100s OF FREE AND EASY KNOCK-OFF FURNITURE PLANS TO SAVE YOU \$1000s

PLANS: Tryde Media Console

SHOPPING LIST

Quantity	Description
1	¾" Plywood or MDF, cut into strips 15 ½" wide, 8' long (these will be called 1x16 boards)
1	1x12, 6' Long
2	1x2, 8' Long
3	2x4s, 9' Stud Length
1	1x3, 8' Length
1	½ Sheet of ¼" Plywood
1	4x4 Post, Untreated (additionally, you could use sandwiched 2x4s, but the dimensions will change slightly)
2	1x2, 8' Length
	1 1/4" Finish Nails
	2" Finish Nails
1	Small Tube Wood Glue
	Sandpaper
	Finishing Supplies including wood filler

RECOMMENDED TOOLS

Measuring Tape, Square, Saw, Drill with Countersink Bit, Finish Nailer, Sander, Clamps

CUT LIST

	Quantity	Board	Length	Description
A	2	1x16	46 1/2"	Shelves
B	2	1x16	13 1/2"	Sides
C	2	1x16	12"	Cubby Divider
D	1	1x16	20"	Shelf
E	1	1/4" Plywood	13 ½"x 48"	Back
F	4	1x3	14 1/2"	Spacers
G	4	4x4	22 1/2"	Legs
H	2	¼" Plywood	10 ½" x 14 ½"	Side Panels
I	2	1x2	15 ½"	Bottom Supports
J	2	2x4	17 ½"	Breadboard Ends
K	5	2x4	51 ½"	Tabletop Boards
L	1	1x2	48"	Front Trim
M	2	1x2	10 ½"	Side Trim

Copyrighted Material

See www.knock-offwood.com for full disclaimer

ANAWHITEKNOCK-OFFWOOD

100s OF FREE AND EASY KNOCK-OFF FURNITURE PLANS TO SAVE YOU \$1000s

PLANS: Tryde Media Console

IN GENERAL

Refer to the blog at www.knock-offwood.com for any comments or suggestions for this plan. Always wear necessary safety equipment and take safety precautions. Check for square after each step. Measure all joints out and mark clearly with a square on BOTH sides of the joint (so you know where to nail). Use glue unless otherwise stated. Always predrill and countersink any screws. If you are using MDF, avoid fastening too close to the edges to avoid splitting your MDF.

DIMENSIONS AND COMPOSITION

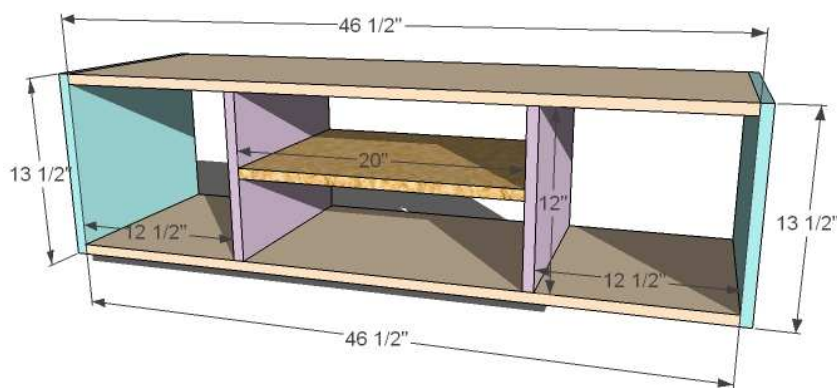
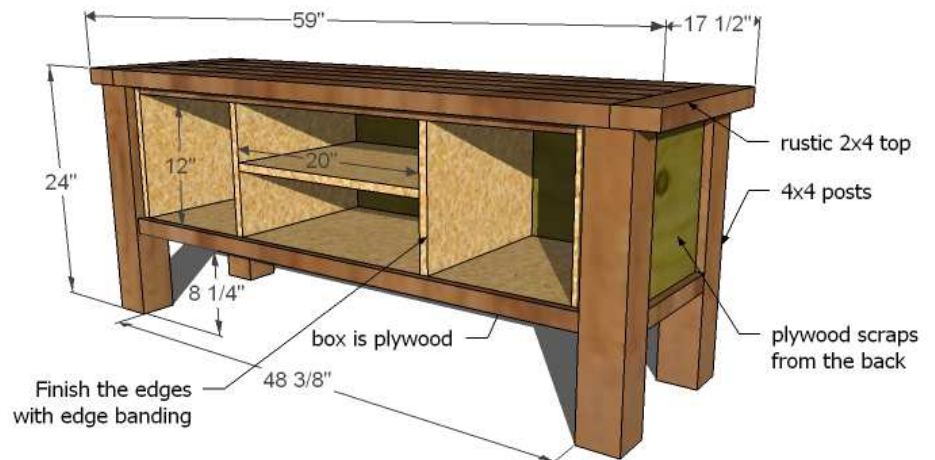

STEP 1: BUILD THE BOX

Mark out all of your joints as shown in the diagram on the cut pieces. Predrill and countersink all screws, using 2" screws and glue. Adjust for square.

Copyrighted Material

See www.knock-offwood.com for full disclaimer

ANAWHITEKNOCK-OFFWOOD

100s OF FREE AND EASY KNOCK-OFF FURNITURE PLANS TO SAVE YOU \$1000s

PLANS: Tryde Media Console

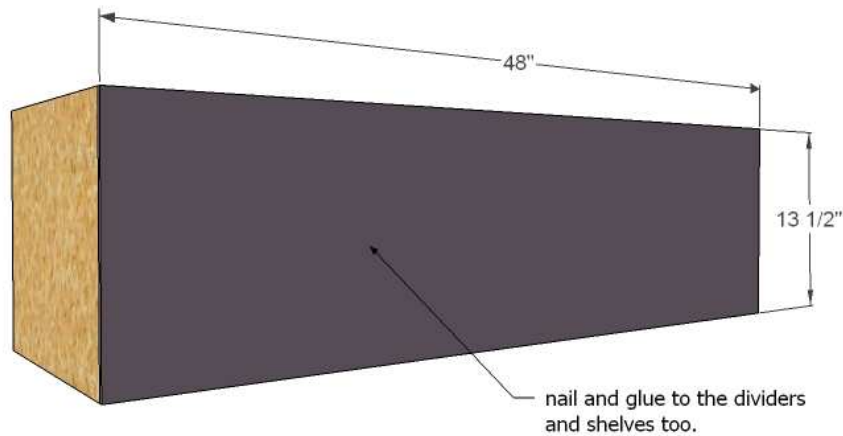

STEP 2: BACK

Attach the back with 1 1/4" finish nails and glue. Also nail to all of the shelves to add strength to the shelves. **TIP:** If your drill is large, you may wish to NOT attach the back until after you have attached the leg structure, as a large drill might not be able to squeeze into the cubby. See step 6.

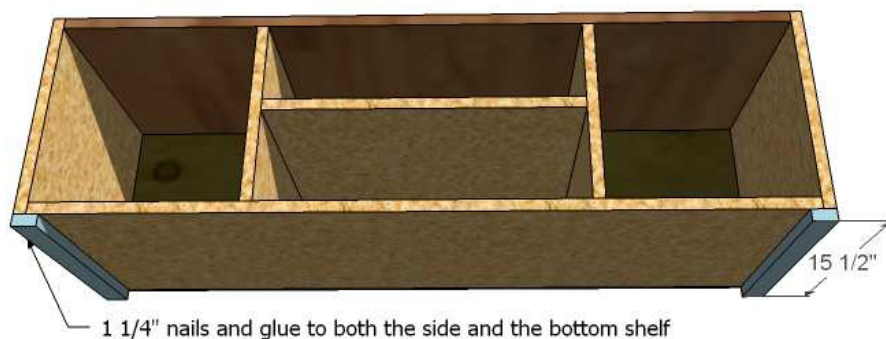

STEP 3: BOTTOM SUPPORTS

You can use screws too on the bottom supports, just don't forget the glue and make sure you keep outside edges flush.

Copyrighted Material

See www.knock-offwood.com for full disclaimer

ANAWHITEKNOCK-OFFWOOD

100s OF FREE AND EASY KNOCK-OFF FURNITURE PLANS TO SAVE YOU \$1000s

PLANS: Tryde Media Console

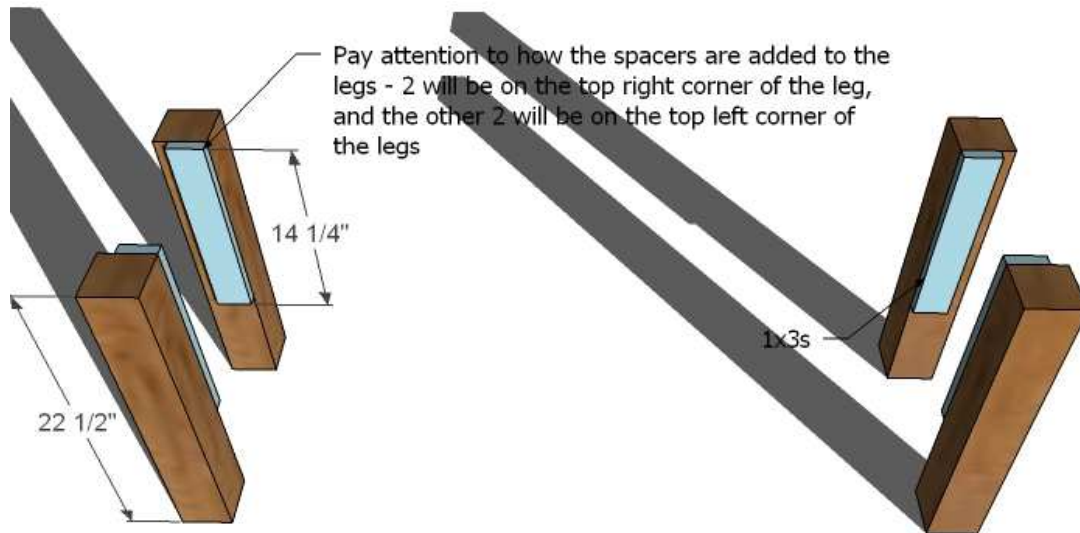

STEP 4: LEGS

Attach the spacers to the legs as shown above. Use 1 1/4" nails and glue.

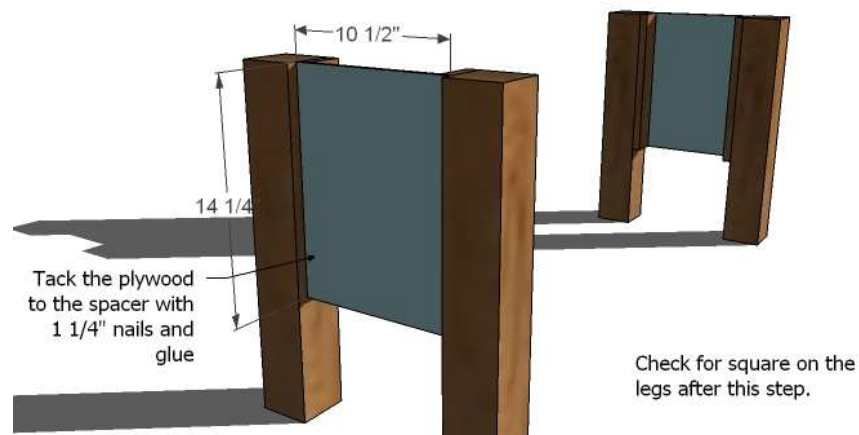

STEP 5: SIDE PANELS

Attach the side panels to the spacers using 1 1/4" nails and glue as shown above. Check for square.

Copyrighted Material

See www.knock-offwood.com for full disclaimer

AN WHITE KNOCK-OFF WOOD

100s OF FREE AND EASY KNOCK-OFF FURNITURE PLANS TO SAVE YOU \$1000s

PLANS: Tryde Media Console

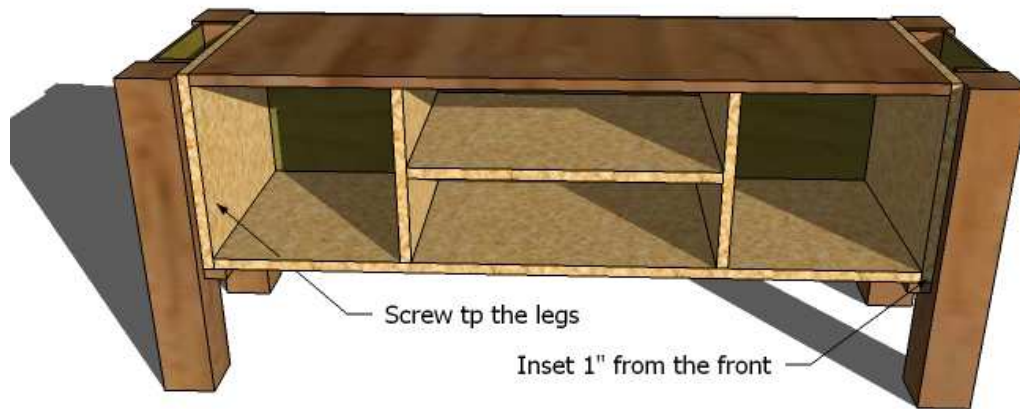

STEP 6: ASSEMBLY

Screw the box to the legs as shown above. If you left the back off, attach the back during this step. Use glue and adjust for square. **TIP:** Turn everything upside down to attach the legs to the box on a level surface.

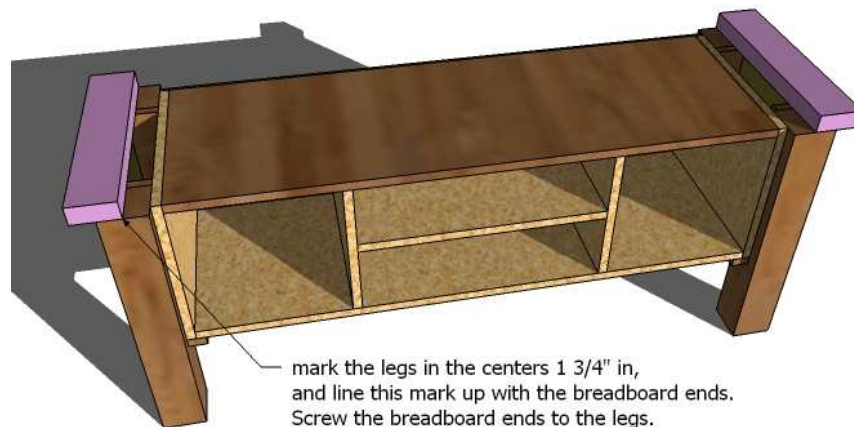

STEP 7: BREADBOARD ENDS

Attach the breadboard ends to the top, as shown above. Check for square from the outside corners of your breadboard ends. Use 2" screws and glue.

Copyrighted Material

See www.knock-offwood.com for full disclaimer

ANAWHITEKNOCK-OFFWOOD

100s OF FREE AND EASY KNOCK-OFF FURNITURE PLANS TO SAVE YOU \$1000s

PLANS: Tryde Media Console

STEP 8: TABLETOP

BOARDS

TIP: Cut your boards to size instead of cutting to the cut list for a perfect fit. Screw the Tabletop boards to the top using 2" screws and glue. **TIP:** Mark a screw pattern on the ends of the tabletop boards so that the boards look symmetrical and screws look decorative.

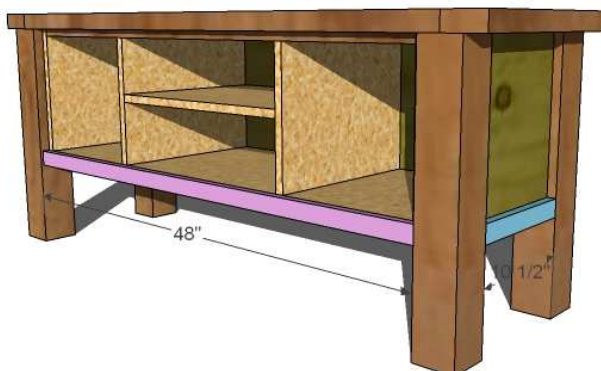
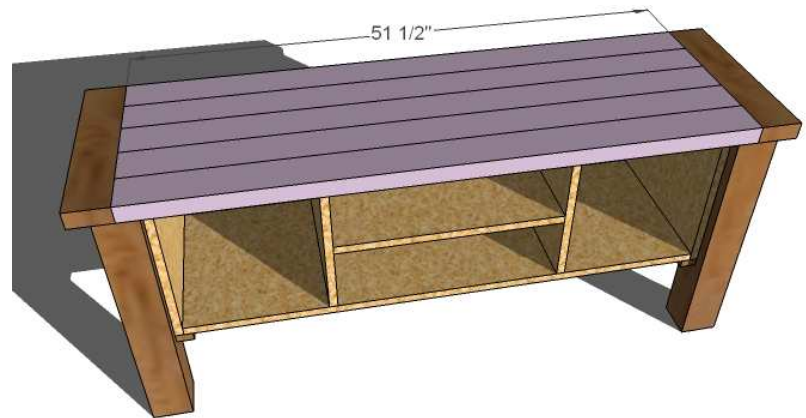

STEP 9: TRIM

Attach the bottom trim pieces as shown above using 1 1/4" nails and glue.

FINISHING

Fill all holes with wood filler. Sand with coarse sandpaper. Fill holes with wood filler again, and sand with medium grit sandpaper. Then finish with a fine sandpaper. Always sand in the direction of the wood grain. If you are painting, prime, painting the insides first, outsides last. Add two coats of paint. You can add a clear top coat if you wish. For staining, always test out a scrap piece, with wood filler. If the wood filler is not taking stain, you may wish to buy a color coordinated wood filler and fill your holes with this. If the stain is going on blotchy, you may need to apply a wood conditioner prior to the stain. Apply a top coat if necessary.

Copyrighted Material

See www.knock-offwood.com for full disclaimer