

Wood Tilt Out Trash or Recycling Cabinet

[View \(/woodworking-projects/wood-tilt-out-trash-or-recycling-cabinet\)](/woodworking-projects/wood-tilt-out-trash-or-recycling-cabinet)

[Edit \(/node/1963/edit\)](/node/1963/edit)

[Delete \(/node/1963/delete\)](/node/1963/delete)

SUBMITTED BY ANA WHITE (/USERS/ANA-WHITE) ON THU, 05/30/2019 - 09:21



Difficulty: **Intermediate**

Solid wood tilt out trash cabinet or recycling cabinet plans. You'll love the step by step instructions and diagrams, shopping list and cut list.

About Project

We love this wood tilt out trash bin because it's a cabinet with a countertop surface, while still providing easy access to the trash. You can choose your own paint or stain to customize the look.

Dimensions

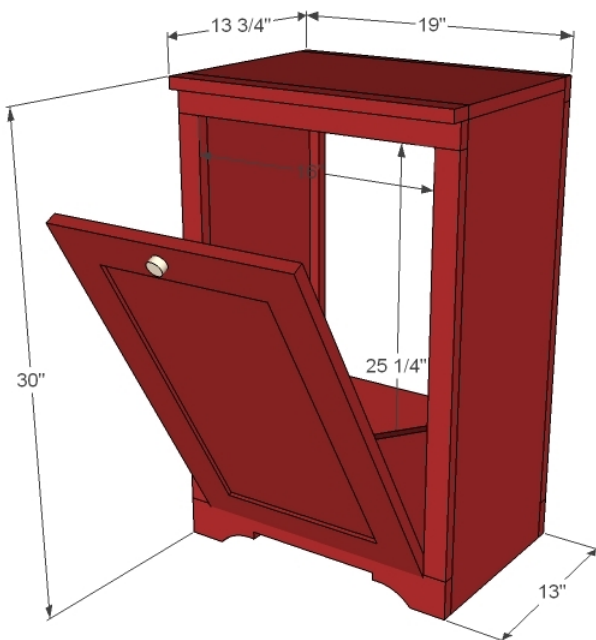

Dimensions shown above. Fits trash can less than 16" wide x 22" high x 12" deep overall.

Preparation

SHOPPING LIST

2 - 1x12 @ 6 feet long

1 - 1x3 @ 8 feet long

2 - 1x2 @ 8 feet long

Narrow Hinges (the cheapo kind with flat headed screws)

Knob or Pull

Wire or toolbox lid support hinge to keep the door from opening all the way to the floor

COMMON MATERIALS

2 inch screws

1 1/4 inch finish nails

2 inch finish nails

1-1/4" Pocket Hole Screws (http://www.amazon.com/gp/product/B0006444U2/ref=as_li_tl?ie=UTF8&camp=1789&creative=390957&creativeASIN=B0006444U2&linkCode=as2&tag=knooffwoo-20&linkId=5AJJGUAWGYX2TT7E)

Elmer's Wood Glue (<http://elmers.com/diy>)

Elmer's Wood Filler (<http://elmers.com/products/wood-filler-and-other-repair?filters=construction#>)

120 grit sandpaper

primer

wood conditioner

paint

paint brush

CUT LIST

2 - 1x12 @ 29 1/4"

1 - 1x12 @ 19"

1 - 1x12 @ 17 1/2"

2 - 1x3 @ 19"

3 - 1x2 @ 19"

2 - 1x2 @ 26" (Back)

2 - 1x2 @ 25 1/4" (Front)

DOOR

Door overall 1/4" less than opening

1 - 1x12 @ 12" cut in half diagonally - trash holder sides

1 - 1x12 the width of the door (approximately 15 3/4") - trash holder bottom

TOOLS



Tape Measure



Speed Square



Pencil



Safety Glasses



Ear Protection



Kreg Jig



Drill



Circular Saw



Jigsaw



Brad Nailer



Sander



Drill Bit Set

Instructions

STEP 1

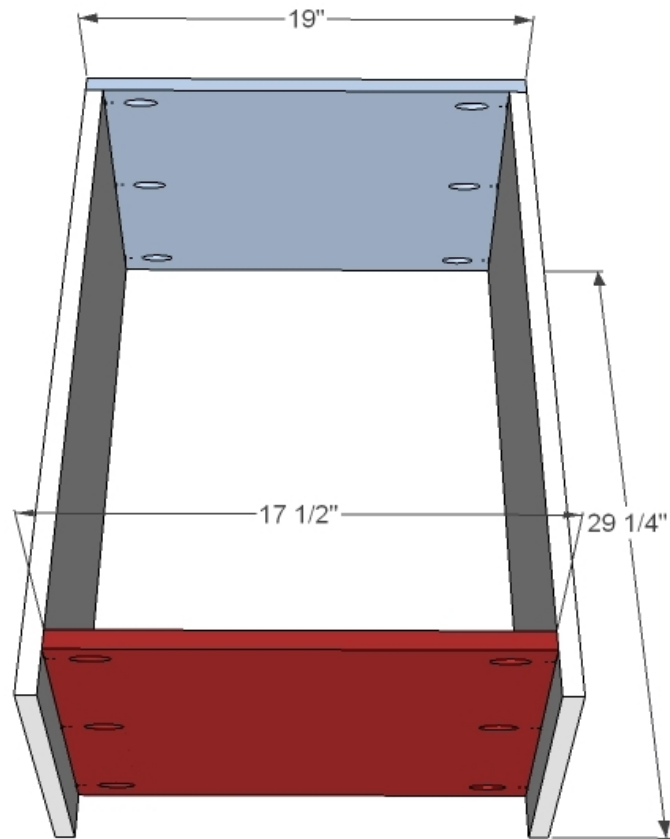

Use either a Kreg Jig (<http://www.kregtool.com/files/anawhite/anawhite.asp>) or 2" screws or finish nails to build your box as shown above. The bottom shelf is 2 1/2" from the bottom, at the top. So leave 1 3/4" gap underneath the bottom shelf. Check for square.

STEP 2

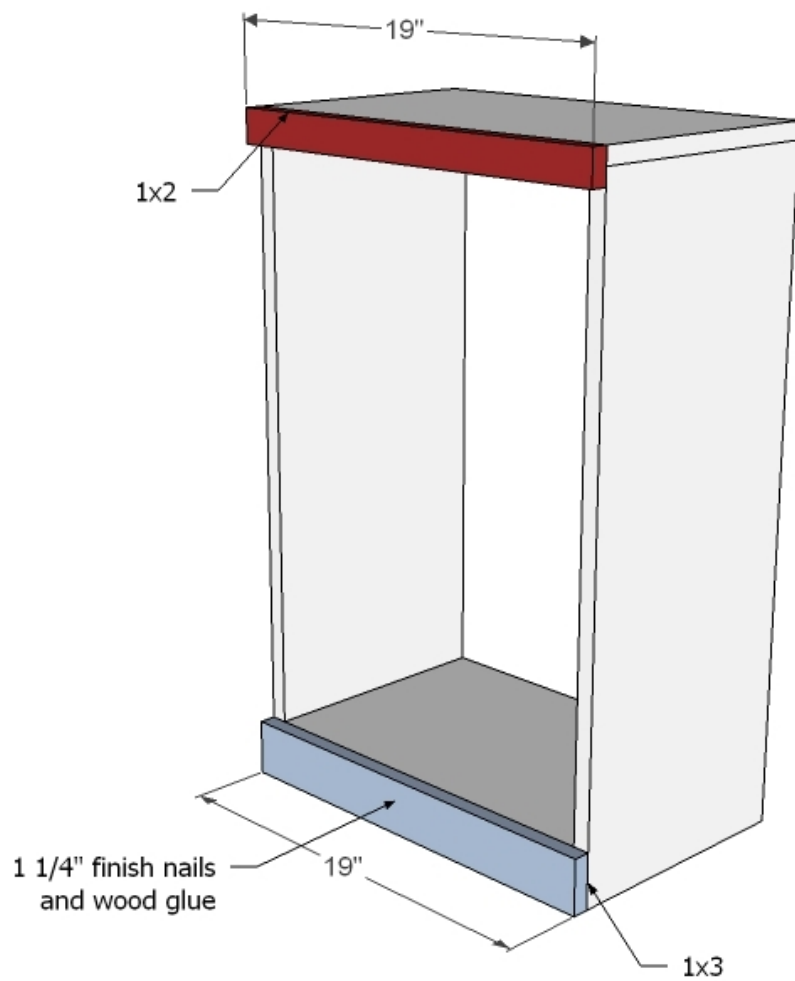

Once your box is done, choose the less attractive side and attach trim as shown above. I used 1 1/4" brad nails and glue.

STEP 3

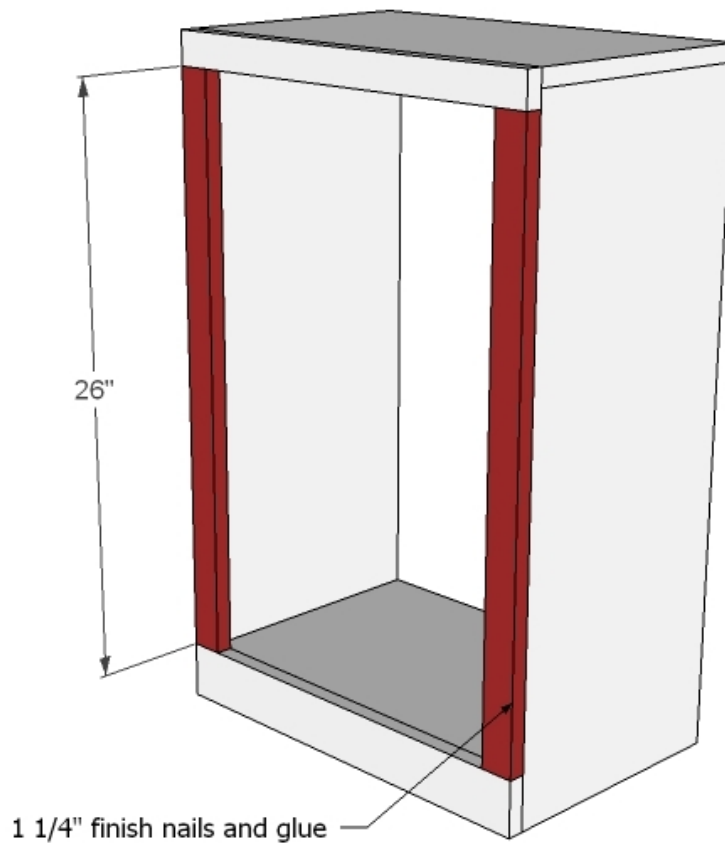

Now the sides on the back. You can also choose to cover the back in 1/4" plywood, but I personally wanted an easy means of both changing trash bags and cleaning the cabinet out. So my trash bin is actually open on the back.

STEP 4

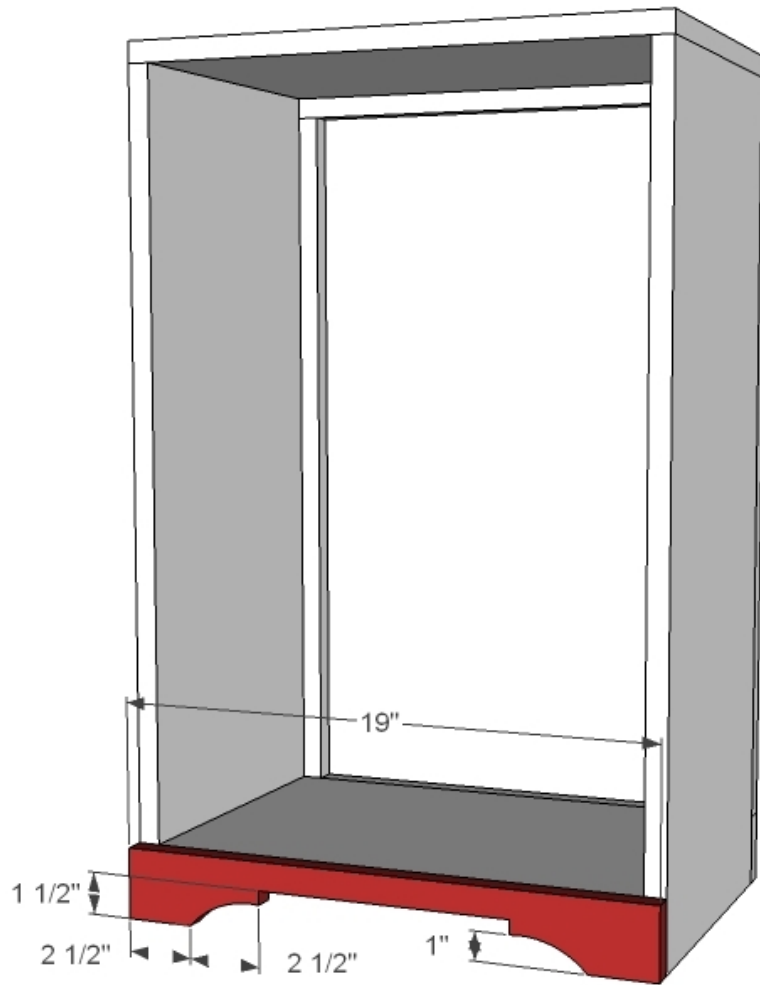

Now the front. I like to cut footers out in place because you don't have to worry about clamping it down or anything like that. Nail down and then mark as shown in the diagram (you can click images for a larger view) and cut out with a jigsaw.

STEP 5

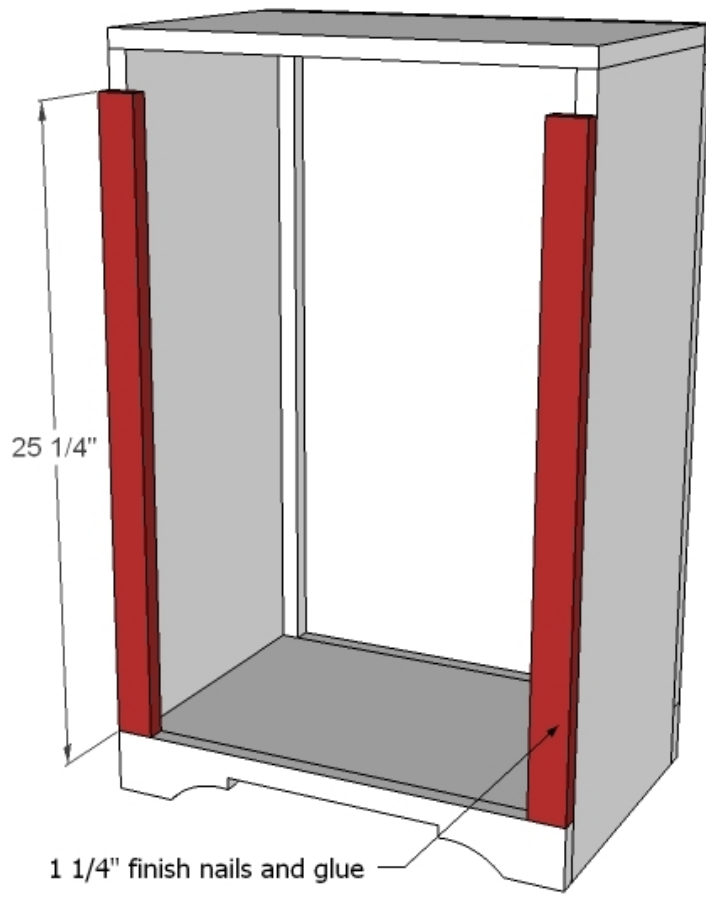

STEP 6

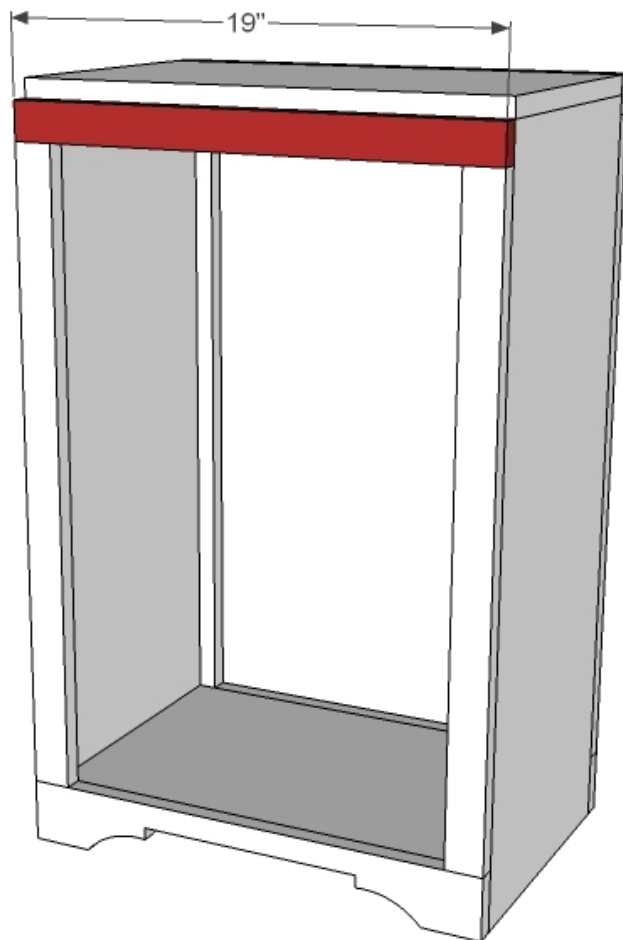

And the front. Notice that the top has a 3/4" gap. This is good.

STEP 7

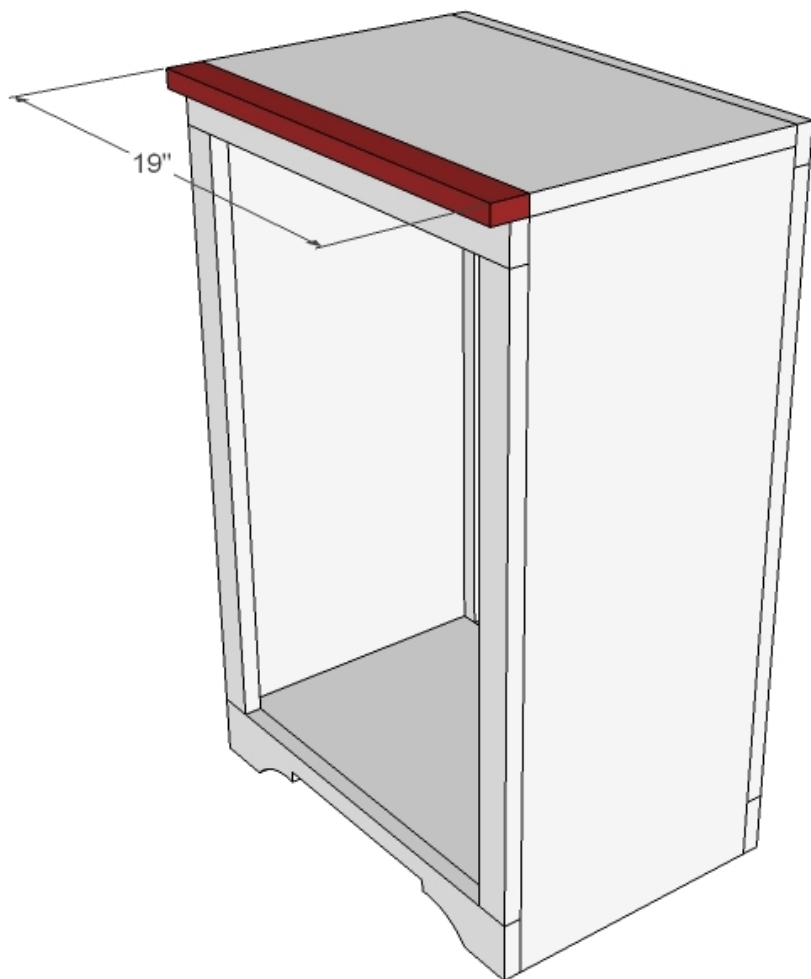

Finally the front edge. Nail and glue in place. This completes the cabinet construction.

STEP 8

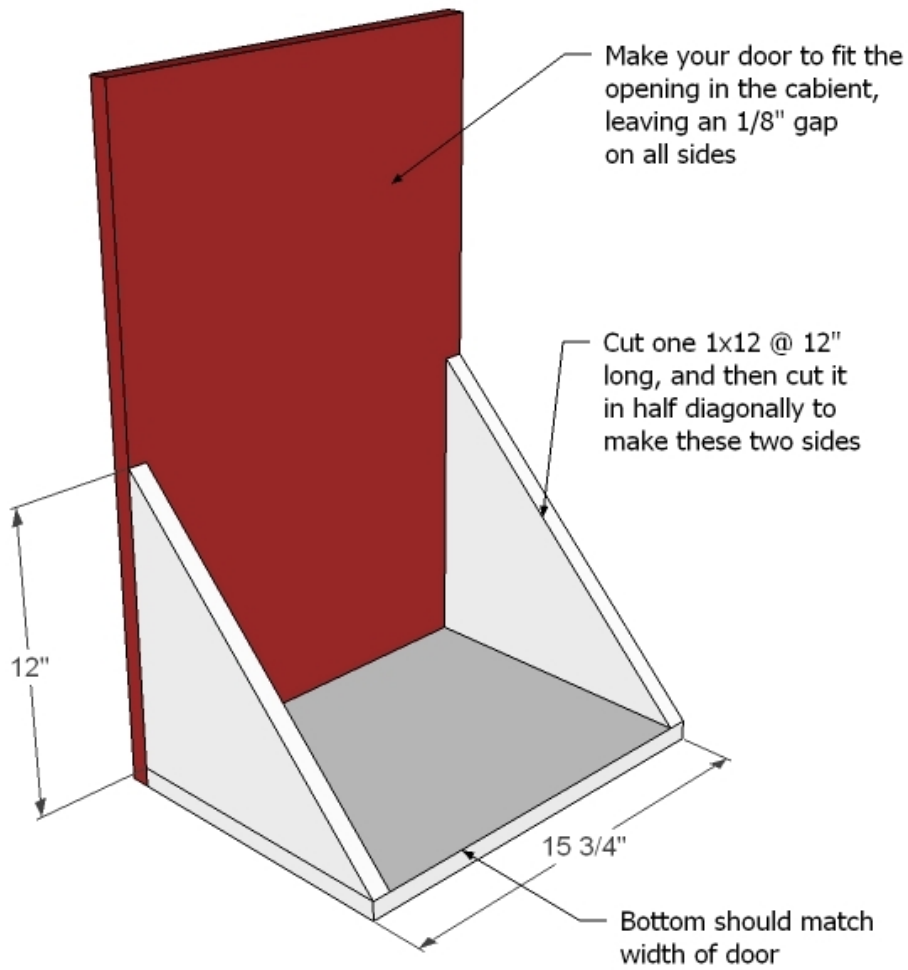

It's time to move on to the door!

The door itself should be built 1/4" smaller than the opening in the front of the cabinet. You can use a full piece of 3/4" thick plywood, or create a face frame from 1x3s or 1x4s and attach 1/4" plywood to the back of the door face frame (attach the 1/4" plywood inside the trash can holder pieces).

Build the trash can holder as shown, securing to the door either with pocket holes or with screws from the front.

STEP 9

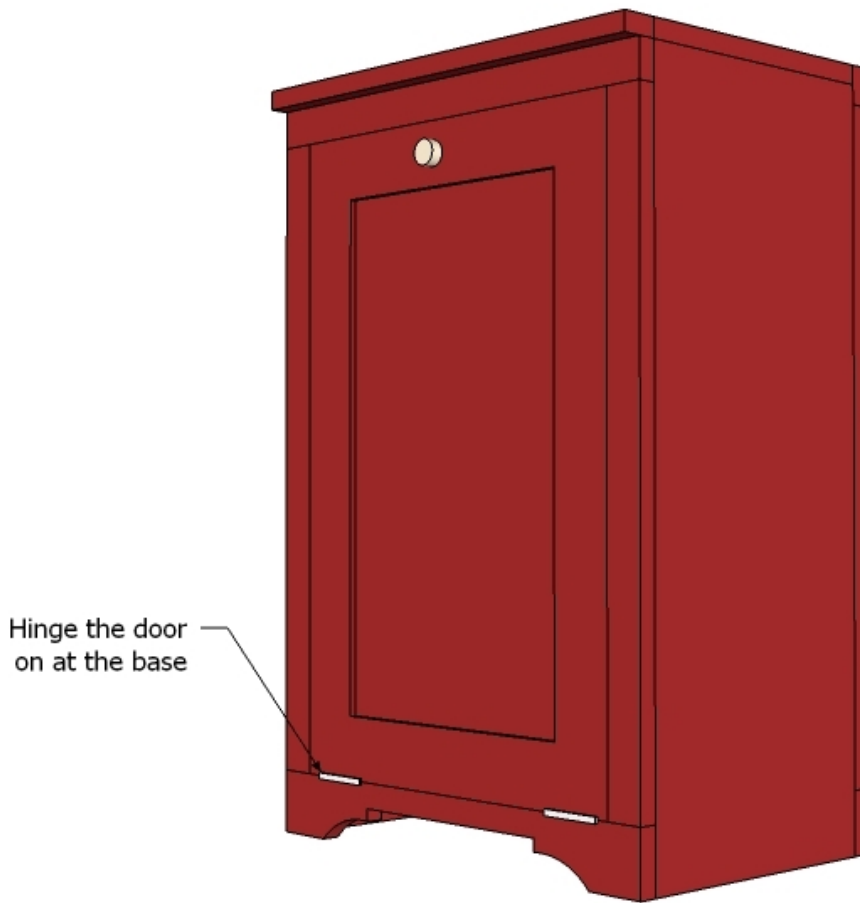

Hinge the door
on at the base

And then just hinge the door to the cabinet. For our tilt out trash cabinet/recycle center, we didn't even have to worry about a magnetic catch - the weight of the tilt out base keeps everything closed nicely.

However, you may need to install either hardware or a chain to keep the tilt out door from opening all the way and bruising your toes.

Add new comment (/woodworking-projects/wood-tilt-out-trash-or-recycling-cabinet#comment-form) 4636 views